

Warranty Period : 1 year

(from the date of your purchase)

For more details, read the attached "Minoura Limited Warranty Policy" card.

Please refer to our website for any updated information.

Applicable Frame

Front Fork Width : 100mm

Hub nut, 9mm Quick release skewer,
15mm Thru axle

Rear Frame End Width :

Hub nut, 9mm Quick release skewer
120 / 125 / 130 / 135mm

or

12mm Thru axle (142mm width only)

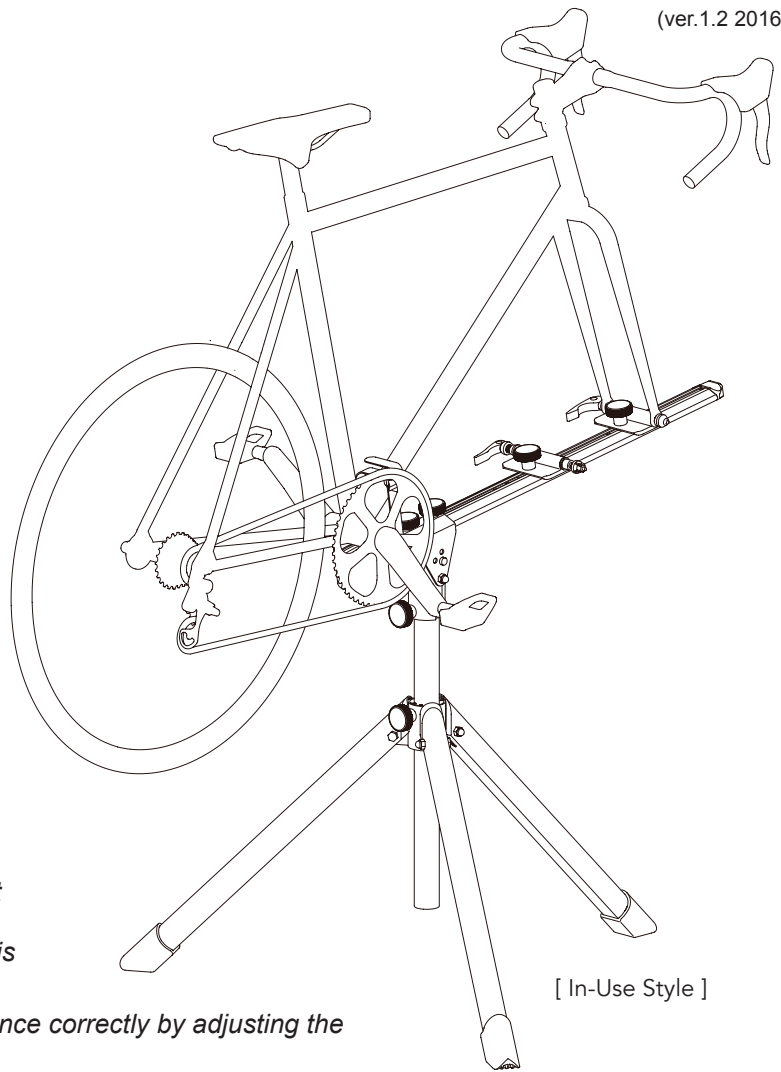

[In-Use Style]

Important Notes

- For standard 2-wheel bicycles only.
Due to the weight balance after removing the front or rear wheel, any longer or heavier bikes are not suitable for use with the RS-1700. Also, RS-1700 is for light-duty maintenance only.
- When mounting the bike, maintain the weight balance correctly by adjusting the main arm position.
In addition, be sure the heavier side of the bike is located just above one of the tripod legs to support the weight safely.
- Use on flat and horizontal floor. Fully open the tripod legs.
- Bicycles that can be safely mounted to the RS-1700 are as follows;
Front fork width is 100mm (plain hub nut, 9mm quick skewer or 15mm thru axle types).
Rear frame end width is either 120, 125, 130 or 135mm (plain hub nut or 9mm quick skewer type) or 142mm (12mm thru axle type).
Any other specs such as narrow 74mm fork width usually found on mini-velo bikes or 20mm thru axle on Downhill bikes cannot be mounted.
- On any bike with hydraulic disc brake, do NOT grasp the brake lever once you remove the wheel.
- When transporting RS-1700, do not just grab the top rubber part (BB Support) only. It may come off due to the stand weight. You must hold the stand frame.
- RS-1700 supports the bike at the bottom bracket. If your bike is equipped with an electric transmission system and its battery is located just next to the bottom bracket, it may not fit RS-1700 properly.
- RS-1700 can be used as the stand for washing bikes because of its unique swivel arm design. But you should dry the stand as quickly as possible after using because some steel parts may rust if it stays wet.
- Use the included Velcro strap to securely hold the bike and keep it in the stand.

Contact

If you have any questions or need help, you should contact the dealer where you purchased or the Minoura distributor in your country first. Only when you cannot get enough service, you can contact us.

MINOURA JAPAN (for ALL customers)

1197-1 Godo, Anpachi, Gifu 503-2305 Japan

Phone: +81-584-27-3131 / Fax: +81-584-27-7505

Email: minoura@minoura.jp / Web: www.minoura.jp

MINOURA North America (for U.S. residents ONLY)

California, U.S.A.

Phone: 1-510-538-8599 / Fax: 1-510-538-5899

Email: support@minourausa.com

Made in Japan

Schematics

Each part will be called as mentioned in the right side diagram.

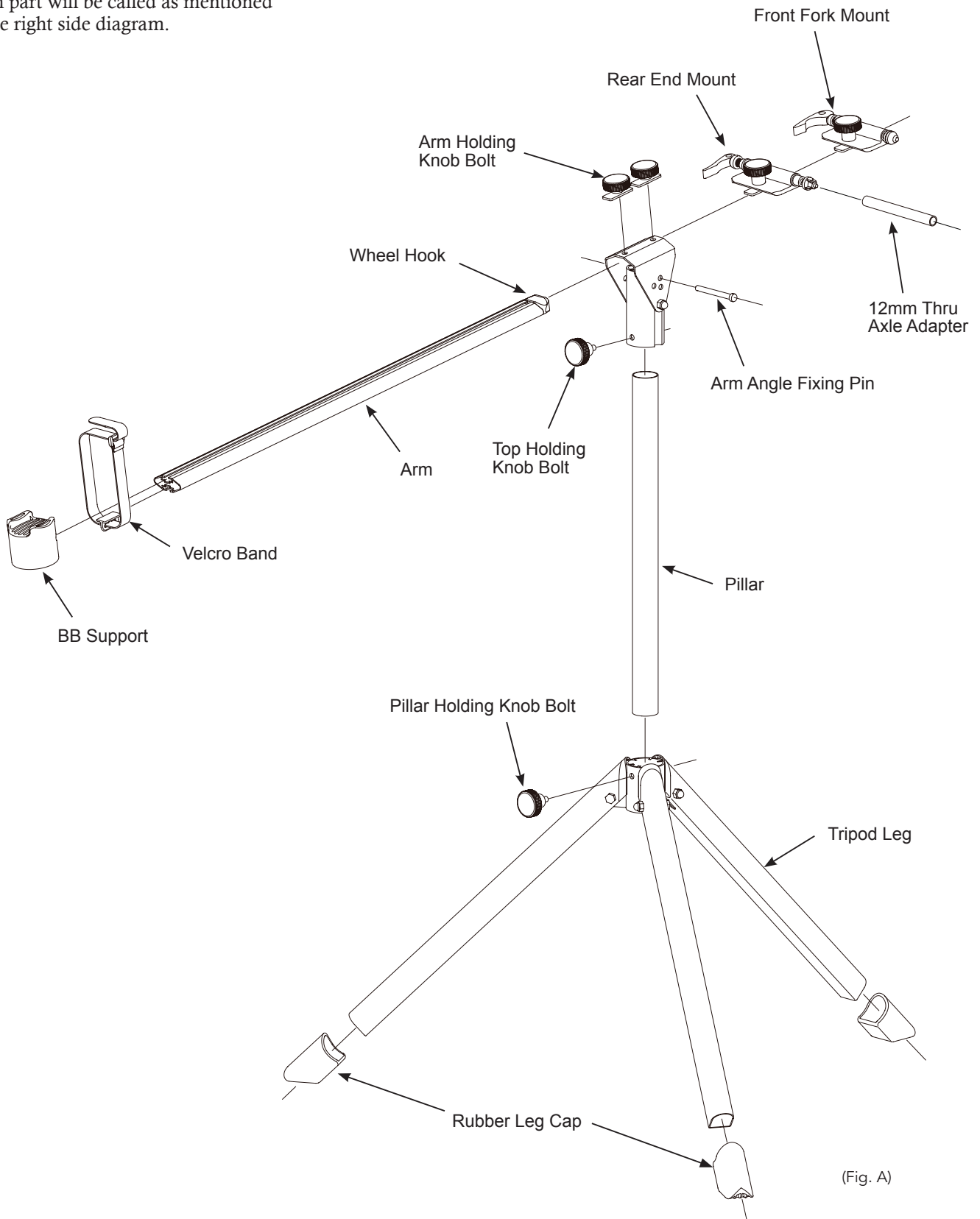

The knob bolts (Top Holding, Pillar Holding, Front Fork Mount and Rear End Mount) are exactly the same and universal. Only the Arm Holding Knob Bolt has different (shorter) bolt length.

Prepare To Use RS-1700

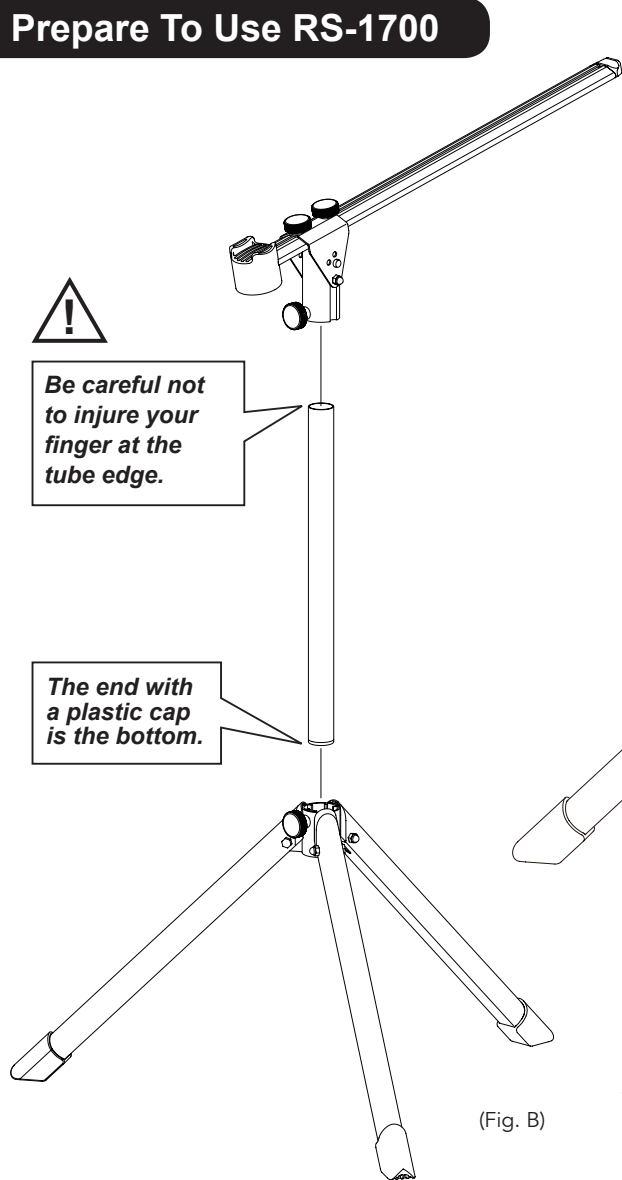

(Fig. B)

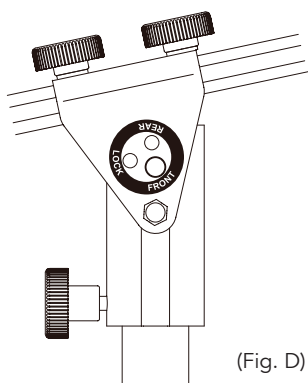

(Fig. D)

Arm Angle Fixing Pin Insertion Position

- | | |
|--------------|--|
| FRONT | : Lower angle for mounting at the front fork |
| REAR | : Higher angle for mounting at the frame end |
| LOCK | : To flock the Arm not to open |

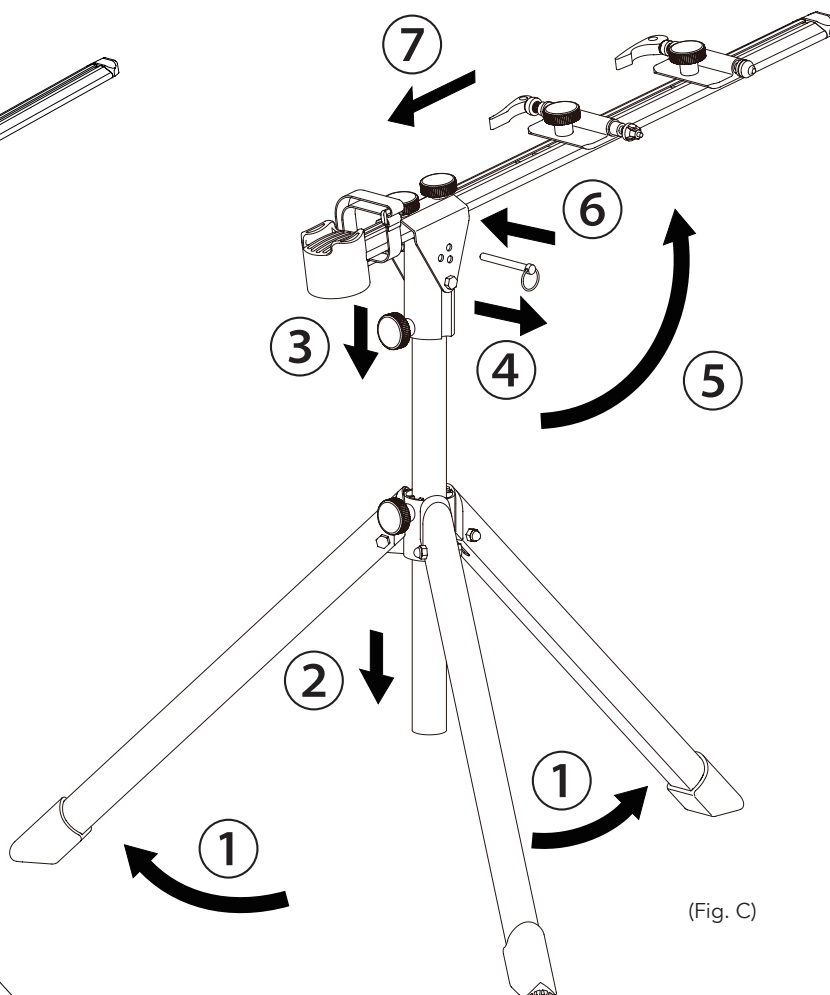

(Fig. C)

RS-1700 is disassembled in the package to protect the surface. Assemble the stand as follows;

- ① Fully open the tripod legs and place it on the flat and horizontal floor.
- ② Loosen the Pillar Holding Knob Bolt, put the Pillar into the center tube of the Tripod base, then tighten the knob bolt to hold the Pillar position temporarily. Make sure the pillar direction that the plastic cap side is located at the bottom.
- ③ Fully insert the tube section of the Arm into the Pillar top, then tighten the Top Holding Knob Bolt.
- ④ Pull out the Arm Angle Fixing Pin.
- ⑤ Raise up the Arm.
- ⑥ Insert the pin into the FRONT hole if you will mount the bike with the front fork. Insert the pin into the REAR hole if you will mount the bike by holding the frame end (see Fig. D) to fix the arm angle.
- ⑦ Loosen the Arm Holding Knob Bolts to allow to slide the Arm. Tighten the knob bolts to hold the position.
- ⑧ To fold down the Arm, turn the Arm to be located between two legs, pull out the pin to fold the Arm, then insert the pin into the LOCK hole to fix.

Front Fork Mount & Rear End Mount

The Front Fork Mount and the Rear End Mount will be installed to the Arm by screwing the knob bolt to the plate nut in the top groove of the Arm. (see Fig. E)

In the package, just the knob bolts and the plate nuts have been set on the Arm.

Make the Arm horizontal, remove the knob bolts, adjust the plate nut position, then install the front fork mount and the rear end mount.

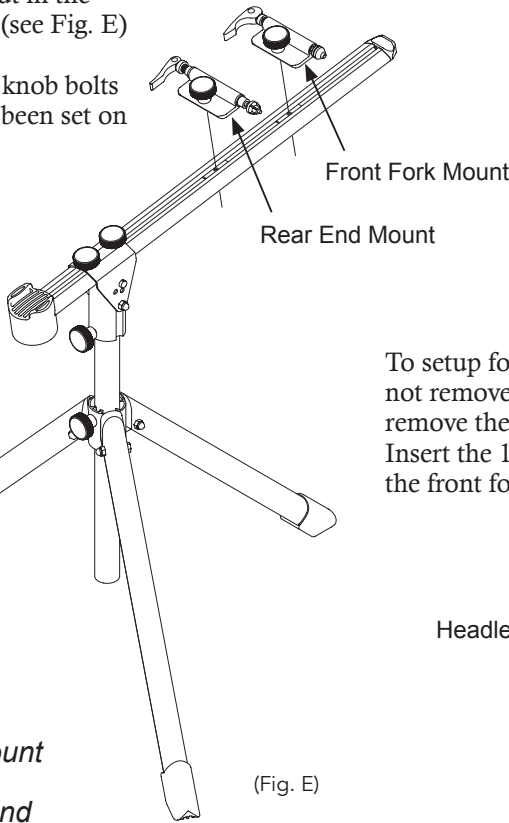

The Front Fork Mount must be located in front of the Rear End Mount.

(Fig. E)



The quick release skewer on the Front Fork Mount is a specially designed wide stroke type. Usually you need to loosen the skewer nut to remove the front wheel due to the projection on tip of the fork, but this skewer allows opening widely by just lever action to make the job quite easier.

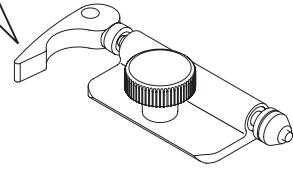

(Fig. F)

To setup for the 15mm thru type axle fork, loosen (do not remove) two headless bolts under the fork mount and remove the red guide sleeve and the quick release skewer. Insert the 15mm axle of your bike into the hole then hold the front fork.

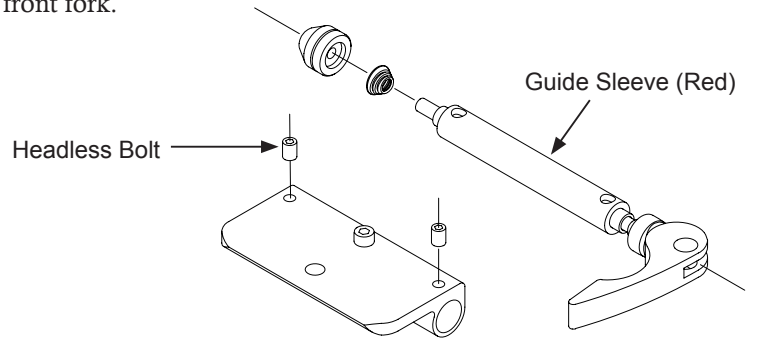

(Fig. G)

The alloy bush on the Rear End Mount is unsymmetric. One side is wider than another side.

By changing the bush insertion combination, this device will fit 4 different sizes (see Fig. H)

The bushes are set for 130mm size in standard. To change it, loosen the headless bolts underneath the Rear End Mount then remove the bush.

To set the 142mm wide 12mm thru type axle, remove both bushes, insert the supplied adapter sleeve and then set the quick release skewer of your bike.

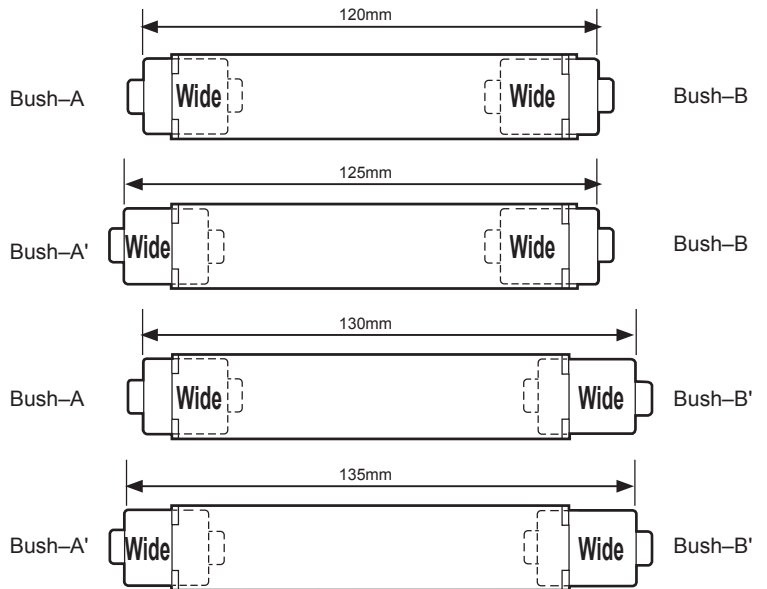

(Fig. H)



If the front fork has conflicts the fork mount, turn around the fork mount to make more space. The rear end mount is the same.



Adjust the adapter length to your bike's frame end width correctly. Failure to do so should cause a serious damage to your bike frame.

Mounting Your Bike Onto RS-1700

- 1** Loosen the Top Holding Knob Bolt to allow to swivel the top arm section. (see Fig. I)



Do not loosen the lower Pillar Holding Knob Bolt. The pillar and the top part will drop down.



If most of the weight is between the legs, the stand may topple due to imbalance. Set the main weight on one of the legs by turning the top part.

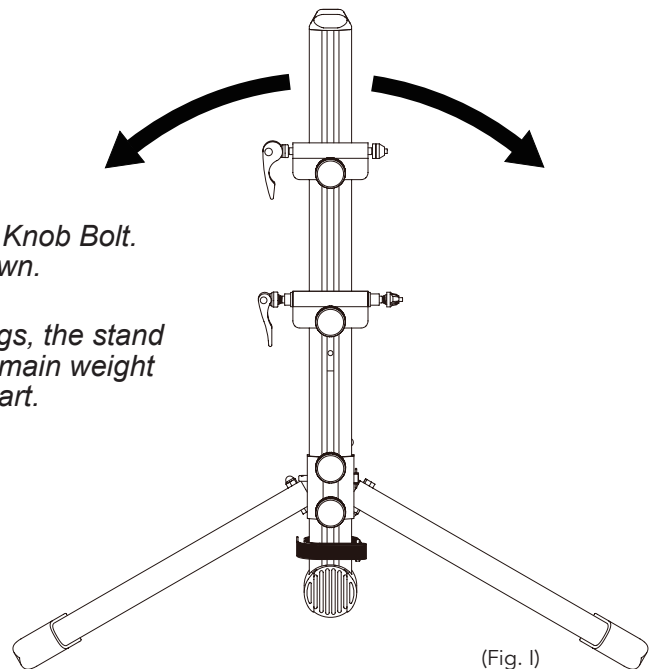

- 2** In case of mounting the bike by the front fork, remove the front wheel. Place the bottom bracket onto the BB Support, and set the front fork to the Front Fork Mount. If the fork mount is not set in correct position yet, loosen the knob bolt to slide it on the arm. Tighten the knob bolt firmly after adjusting position.

Open the quick release skewer, insert the tip of the front fork to the skewer axle, and close the lever to hold. If the tightening is not enough, adjust the nut before closing the lever. (see Fig. J)

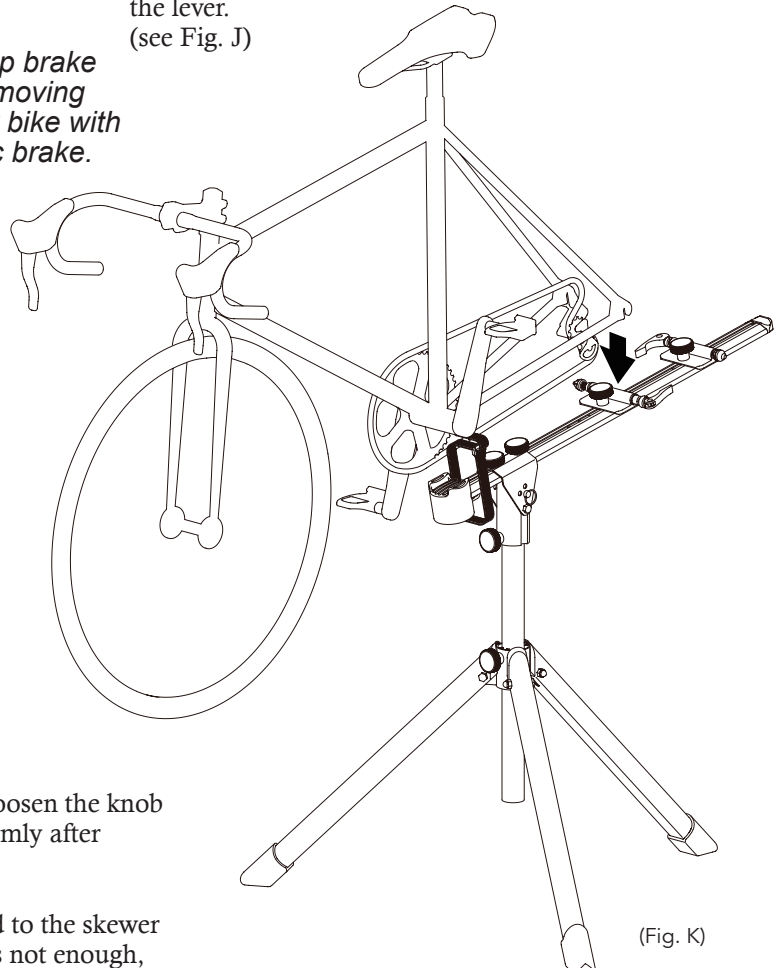
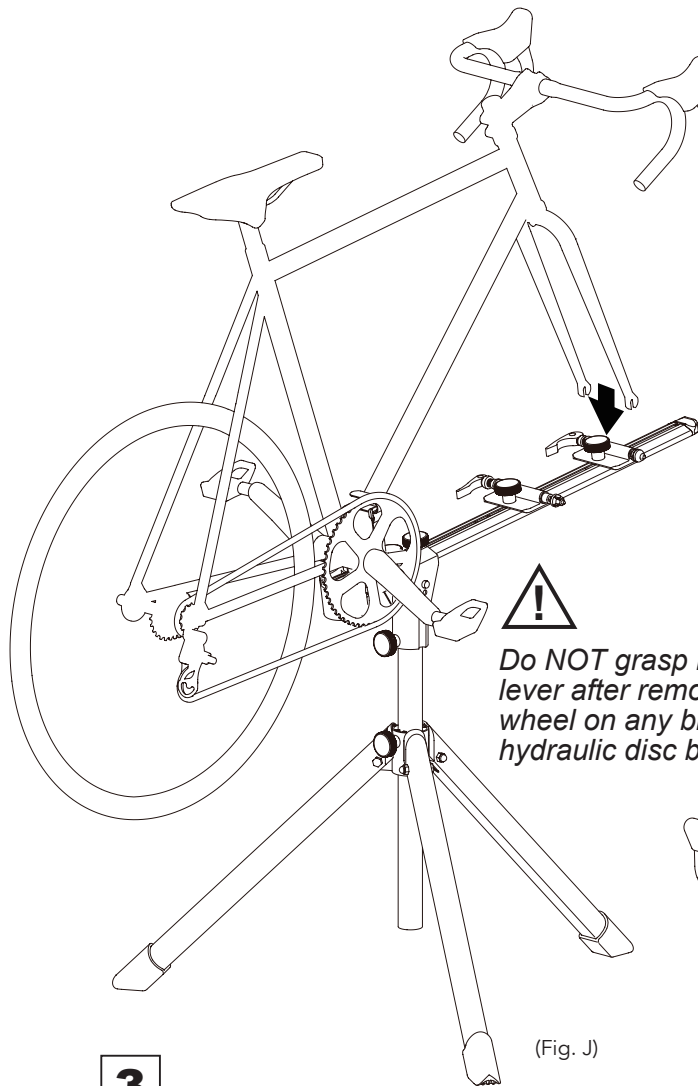

- 3** In case of mounting the bike by the frame rear end, remove the rear wheel. First of all, make sure the Rear End Mount has already been set as its width is exactly same to your bike's rear O.L.D. size. Place the bottom bracket on the BB Support, and place the frame rear end hook onto the Rear End Mount axle.

If the mount is not set in the correct position yet, loosen the knob bolt to slide it on the arm. Tighten the knob bolt firmly after adjusting the position.

Open the quick release skewer, insert the frame end to the skewer axle, and close the lever to hold. If the tightening is not enough, adjust the nut before closing the lever. (see Fig. K)

In case of 12mm thru axle, align the frame end hole to the Rear End Mount hole, then insert the 12mm skewer to hold. (see Fig. L)

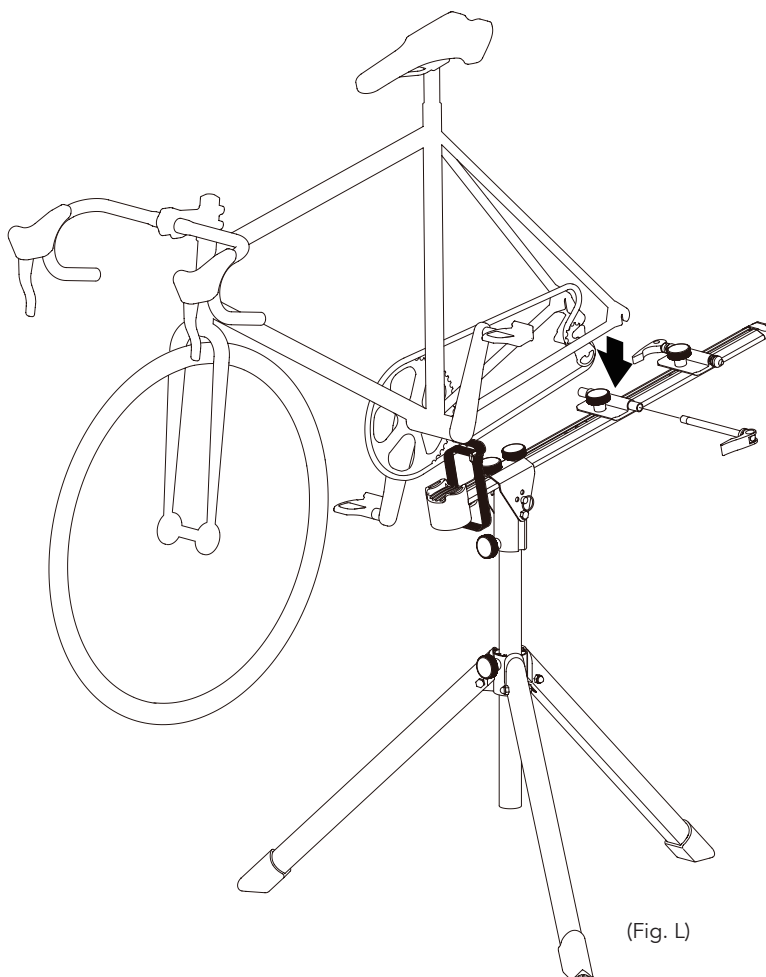

(Fig. L)

3 Hold the bike to the arm securely with the supplied Velcro tape.

Holding With Front Fork

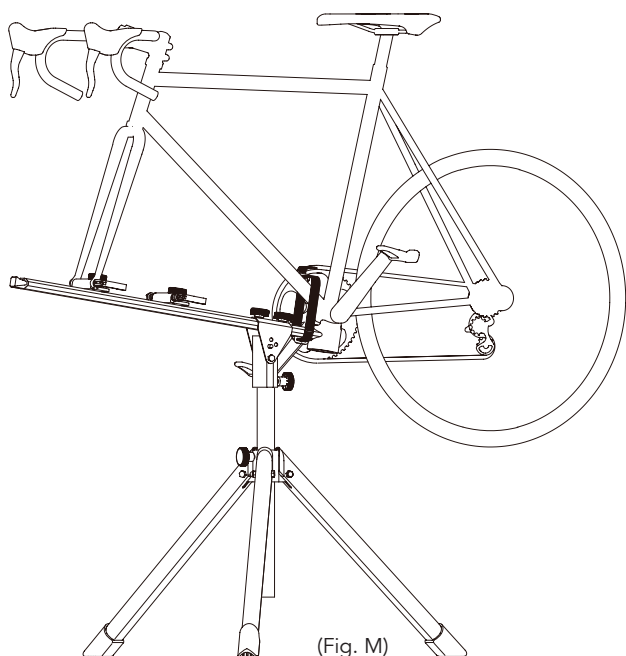

(Fig. M)

Holding With Frame Rear End

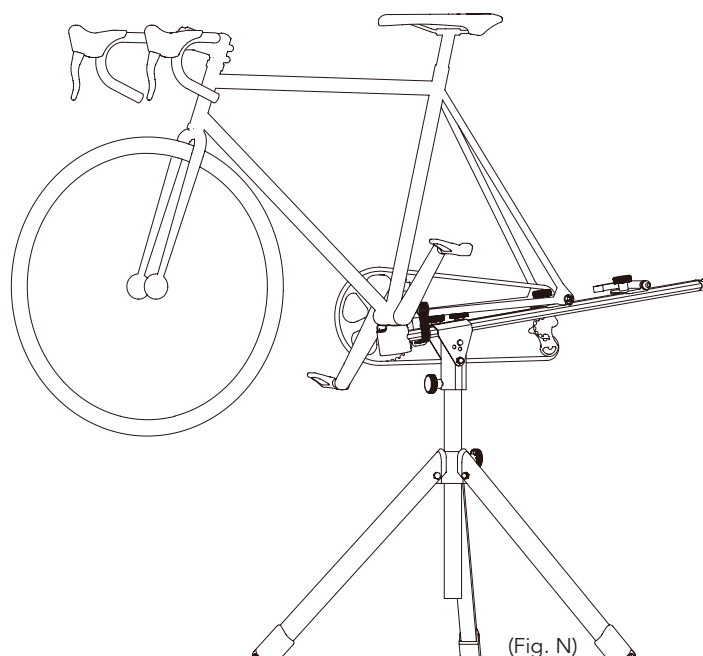

(Fig. N)



Some frames such as carbon monocoque may not be able to be held by the Velcro tape due to the large diameter frame design. If it happens, change the Velcro tape holder position from the bottom to the top of the Arm. To do so, remove the BB Support from the Arm by loosening the small knob bolt under the BB Support, and change the holder insertion gutter.

Holding The Removed Wheel

There is a dimple on tip of the Arm. This is for hooking the removed wheel.

Placing the wheel here also helps balance the bike in the stand and lessens the chance of the stand becoming unstable.

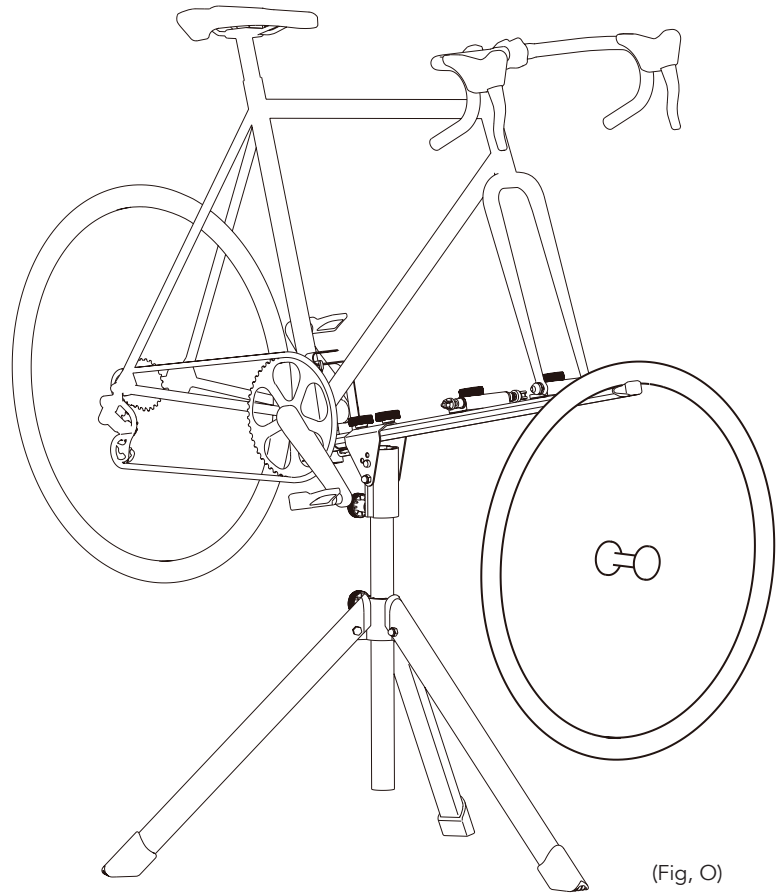

(Fig. O)

Swivel The Bike

By loosening the Top Holding Knob Bolt, the top part swivels even while the bike is in the stand. This provides easy access to both sides of the bike from one position.

The RS-1700 also makes a great stand to wash your bike.



The stand may lose balance when rotating due to the worse weight balance, especially the arm comes between the tripod legs. Support the bike with your hand and rotate slowly.



If you try to lift up the stand even while loosening the Top Holding Knob Bolt, the top part will come off from the pillar. This knob bolt must be tightened securely when in use.



If you leave the stand wet after use, it may rust. Wipe all moisture off before storing. Wipe the moisture as much as possible to dry before storing.

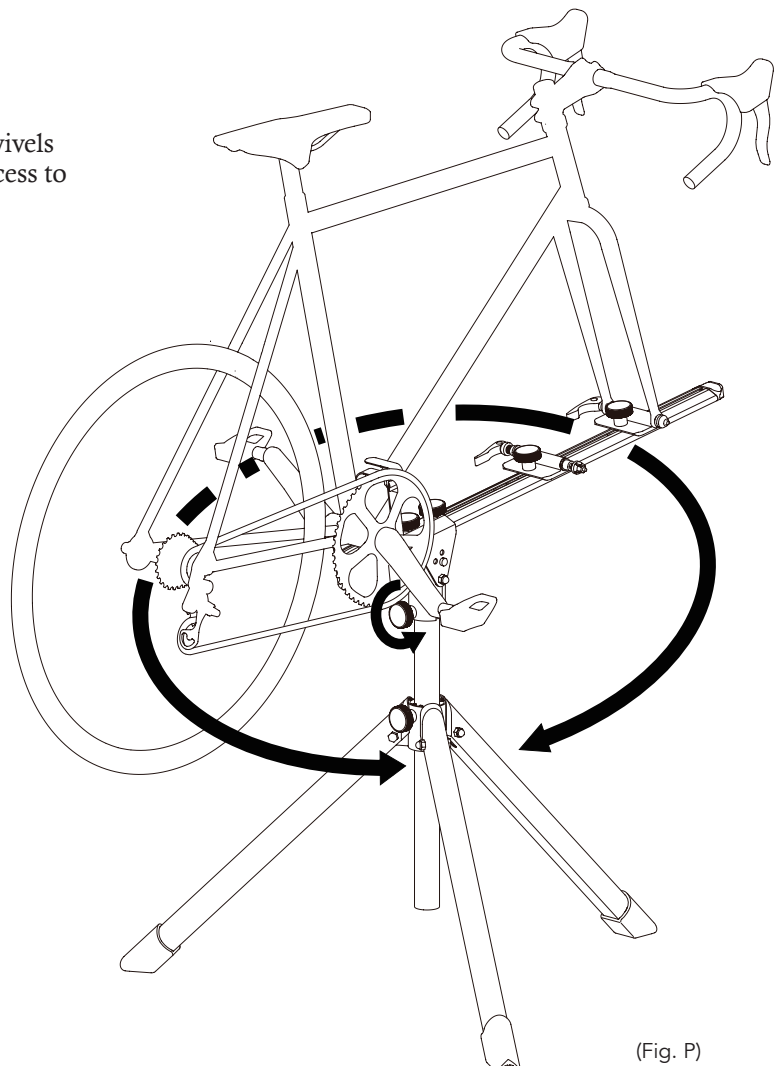

(Fig. P)